

# ANEAS 80x40

Protection 365 days  
a year

This is an ideal model for installation on small terraces and other existing structures, because it is attached by means of supports that can be installed on vertical and horizontal surfaces.

With options for installation between walls, and with or without rails, it is the ideal solution for all types of restaurants and businesses looking to express a personality of their own.



## MOBILISATION



Motorized



Automated



Manual

## INSTALLATION POSSIBILITIES



Terrace



Wrought

- ✓ **Compact size of 80x40** specially indicated for distinguished spaces.
- ✓ **Allows the installation of drop awnings.**



Wall to wall Aneas



Patio cover without crossbar Aneas



Patio cover with crossbar Aneas

## PROFILES

Measurements in mm.

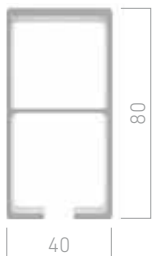

Guide profile

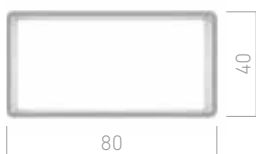

Structural profile

## SUPPORTS

Measurements in mm.



Floor



Wall

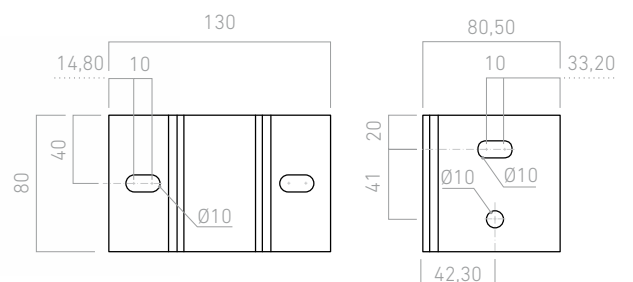
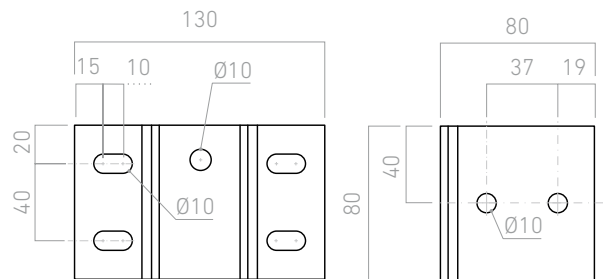

# ANEAS 80x40

## WALL TO WALL

022004

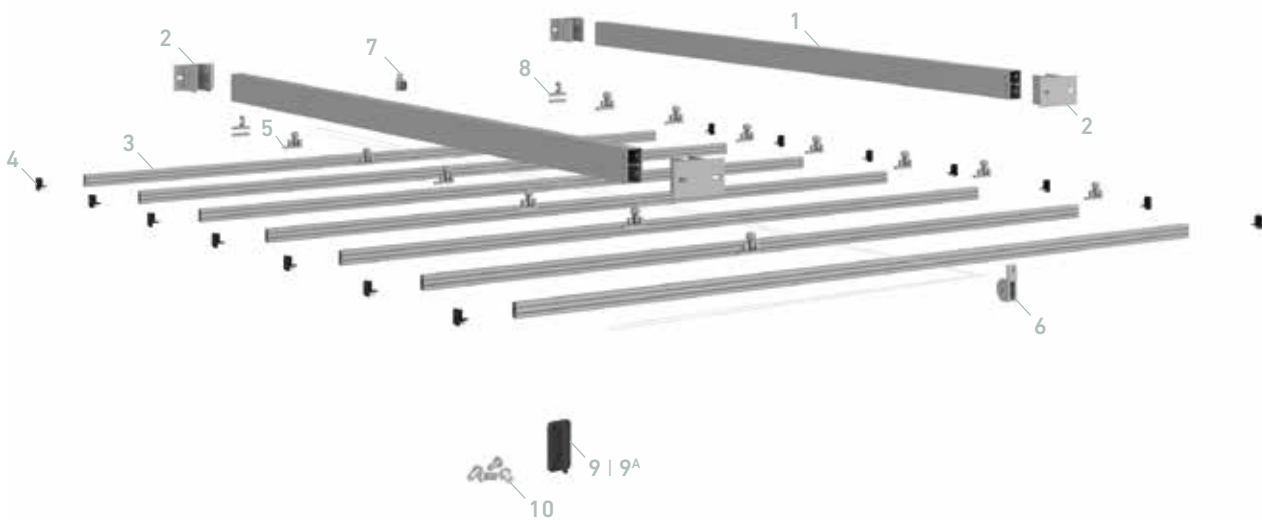

CODE	COMPONENTS
1	022061 Aluminium guide tube 80x40x2 mm
2	022776 Aluminium wall bracket 80x40
3	022520 Double pole cover with holes
4	022277 Cap for double fabric profile with hole
5	022379 Reinforced nylon flange pulley with bearings
6	022084 Simple pulley

CODE	COMPONENTS
7	022593 Double pulley
8	022581 End hook kit
9	022129 Wall cleat for string plastic
9 <sup>A</sup>	022262 Wall cleat for string metallic
10	022115 Bag of screws for bracket
11	022111 Flange with string

### WIND LOAD TEST EN 13561:2004+A1:2008

PROJECTION	2 GUIDES													3 GUIDES			
	WIDTH																
	2,00	2,25	2,50	2,75	3,00	3,25	3,50	3,75	4,00	4,25	4,50	4,75	5,00	5,50	6,00	6,50	7,00
2,00	3	3	3	3	3	3	3	3	3	3	3	3	3	2	2	2	2
2,50	3	3	3	3	3	3	3	3	3	3	3	3	3	2	2	2	2
3,00	3	3	3	3	3	3	3	3	3	3	3	3	3	2	2	2	2
3,50	3	3	3	3	3	3	3	3	3	3	3	3	3	2	2	2	2
4,00	3	3	3	3	3	3	3	3	3	3	3	3	3	2	2	2	2
4,50	3	3	3	3	3	3	3	3	3	3	3	3	3	2	2	2	2
5,00	3	3	3	3	3	3	3	3	3	3	3	3	3	2	2	2	2
5,50	2	2	2	2	2	2	2	2	2	2	2	2	2	1	1	1	1
6,00	2	2	2	2	2	2	2	2	2	2	2	2	2	1	1	1	1
6,50	2	2	2	2	2	2	2	2	2	2	2	2	2	1	1	1	1
7,00	2	2	2	2	2	2	2	2	2	2	2	2	2	1	1	1	1

Class 1	≈ 29 Km/h	Class 2	≈ 38 Km/h	Class 3	≈ 48 Km/h
---------	-----------	---------	-----------	---------	-----------