

# EROS BLIND

ENG

Enjoy the outside while taking care of privacy

Designed to provide vertical shade, this drop awning allows us to create sideways structures thanks to the vertical movement of the canvas, which is guided via extruded aluminum guides.

A system that offers optimum resistance to wind, and which in this Blind version allows the creation of closed spaces that favour privacy.

## MOBILISATION



Motorized



Automated



Manual

## INSTALLATION POSSIBILITIES



Terrace



Wrought

- ✓ Made with **acrylic canvas or PVC.**
- ✓ **The system can be fixed to the floor by means of hinged straps and rings.**



## TYPES OF FIXING

Measurements in mm.

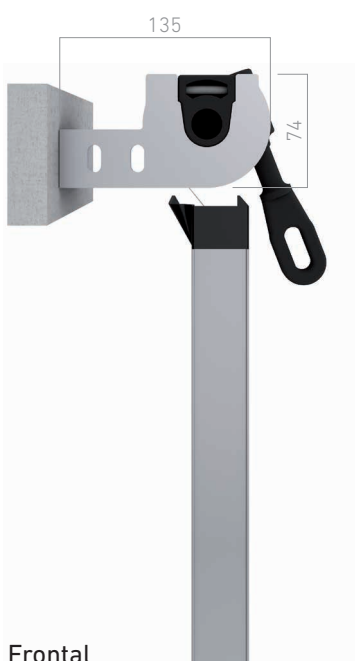

Frontal

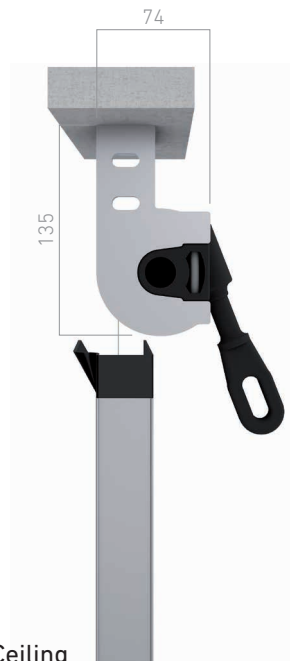

Ceiling

## SUPPORT

Measurements in mm.

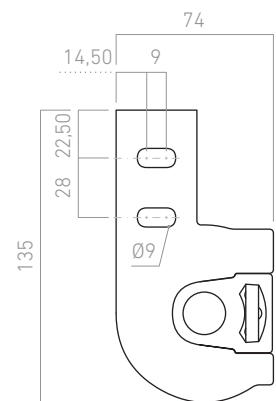

Top bracket

## GUIDE PROFIL

Measurements in mm.

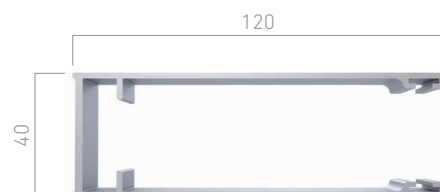

# EROS BLIND

022138

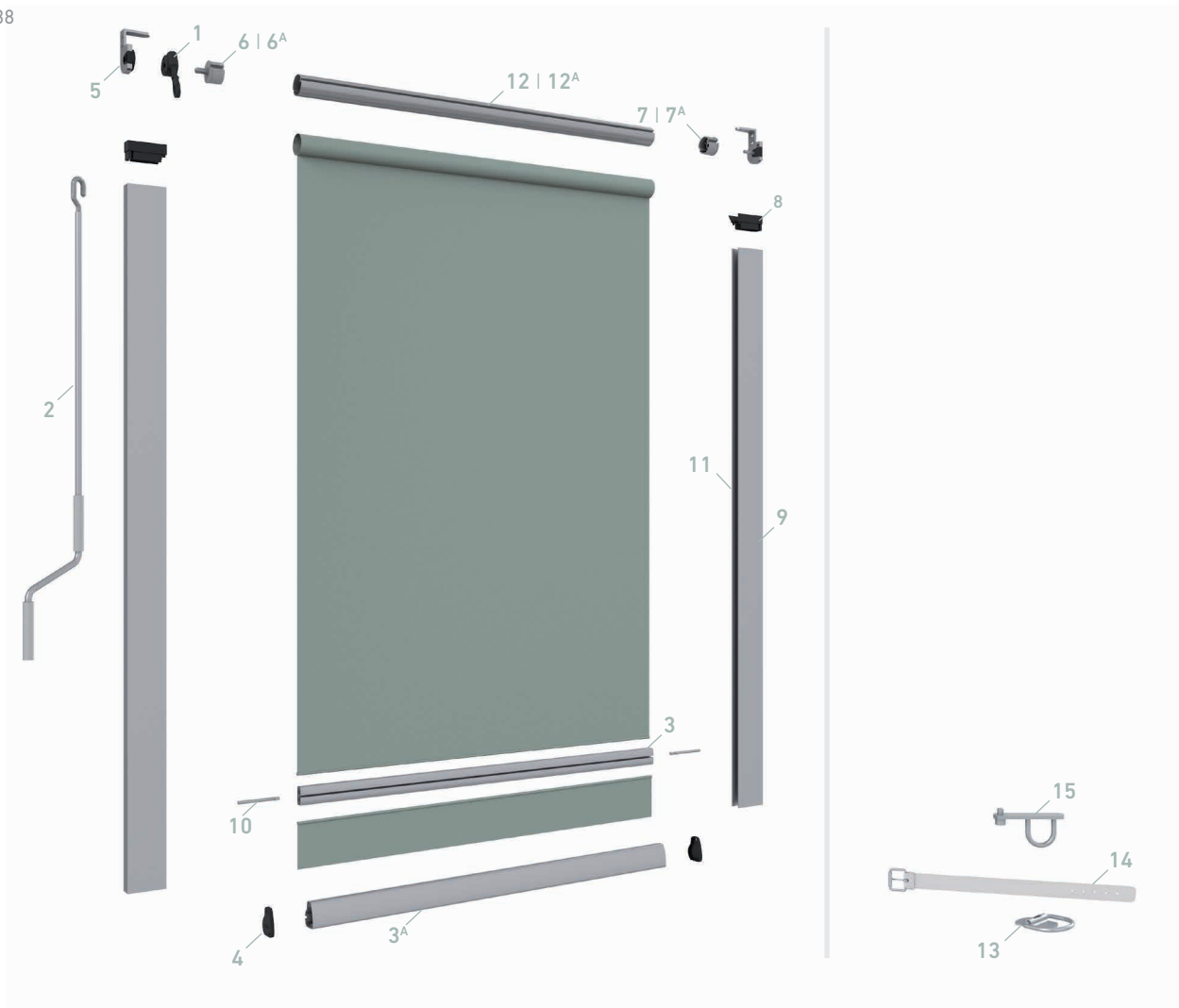

CODE	COMPONENTS
1	024431 Gear Saxun awning 1:7 L80 Long screw
2	022819 Lacquered crank handle with a zined hook
3	024675 Charge profile Eros
3 <sup>A</sup>	022494 Profile Tolper 62 (only assembly without guides)
4	022962 Set of caps for Tolper 62 profile
5	022212 Pair side brackets Paravento
6	022269 Nylon round cap gear 13x35 ø60 square axle (up to 3,75)
6 <sup>A</sup>	022271 Nylon round cap gear 13x35 ø70 square axle (from 3,75)
7	022267 Nylon round cap gear 12x20 ø60 round axle (up to 3,75)
7 <sup>A</sup>	022268 Nylon round cap gear 12x20 ø70 round axle (from 3,75)

CODE	COMPONENTS
8	024077 Pair guide profile bearing 120x40
9	024090 Guide 120x40
10	022092 Windbreaker stainless steel security lock
11	022810 Brush 9x7,3 for windbreaker guide
12	022805 Axle ø60 (up to 3,75)
12 <sup>A</sup>	022806 Axle ø70 (from 3,75)
13	022089 Folding ring (only assembly without guides)
14	022108 Strap with buckle for curtain (only assembly without guides)
15	022090 Bridge flange

## WIND RESISTANCE EN 13561:2004+A1:2008

HEIGHT	WIDTH															
	1,50	1,75	2,00	2,25	2,50	2,75	3,00	3,25	3,50	3,75	4,00	4,25	4,50	4,75	5,00	
2,50	2	2	2	2	2	2	2	2	2	2	2	2	2	2	2	
2,75	0	0	0	0	0	0	0	0	0	0	0	0	0	0	0	
3,00	0	0	0	0	0	0	0	0	0	0	0	0	0	0	0	
3,25	0	0	0	0	0	0	0	0	0	0	0	0	0	0	0	

Class 0	< 29 Km/h	Class 2	≈ 38 Km/h
---------	-----------	---------	-----------

